

farmhouse Voges redux / Hannover / Germany 2009

The project investigates in the innovation potential of the most traditional vernacular domestic type in rural northern Germany, the half timbered house. Way back with extended days out in the fields and the house not much more as a sleep retreat, a very effective tectonical approach, it used wood sparsely and fills in the voids with sod. A greater contemporary demand for open space, natural day lighting and emerged energy efficiency requirements inspired a strategic concept for the redux of this building: The living space on the ground floor “shrinks” in terms of its footprint and “contracts” vertically in the inner core of the building. A new triple glazed thermal zone is able to emerge set back from the structure and as a buffer zone divides the structural and the thermal layers serving as a covered outdoor porch and allows a rain and wind shielded entrance. The intervention gives the hierarchy of space: from below more open and public to above more private a characteristic expression and utilizes a hybridization of Mies’ “Freeplan” with Loos’ “Raumplan”.

found condition



given originally activity /



“Raumplan” and “Freeplan” event / space improvement

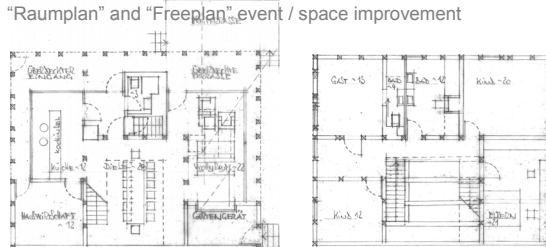

transformation



outdoor dwelling



“Freeplan” open



stripping



inhabited void



substantial surgery



layers



hidden



redux (spatially and environmentally upgraded)



open cooking



house as garden – garden as house



"Raumplan" core

